

IMPORTANT

- © This drawing is copyright and remains the property of this practice
- Do not scale this drawing
- All dimensions to be checked on site
- Positions of existing services to be confirmed prior to proceeding

REVISION STATUS

- S Information issued for feasibility or scheme design
- T Information issued for tender purposes only
- C Information issued for construction
- NB: Only those drawings containing a 'C' revision to be used for construction

NOTES

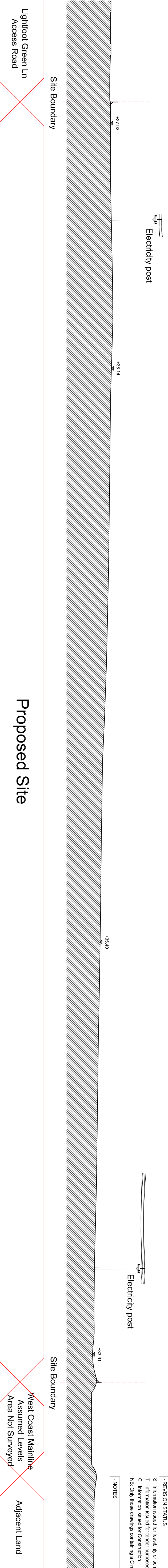

Existing Site Section A-A

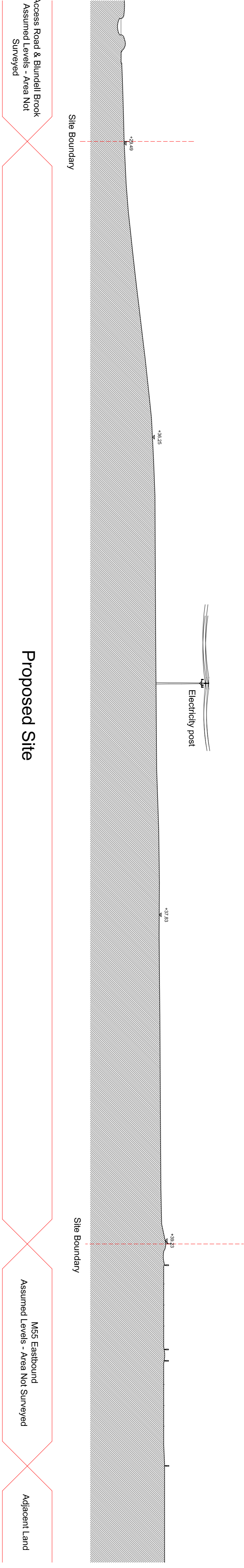

Existing Site Section B-B

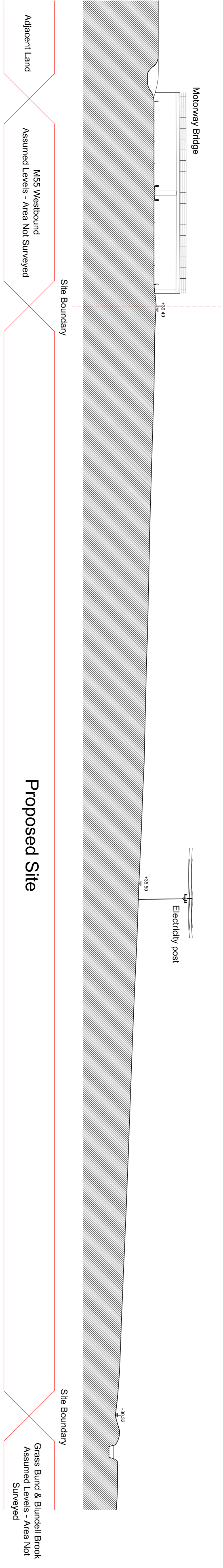

Existing Site Section C-C

Section Location Plan
1:2500@A1

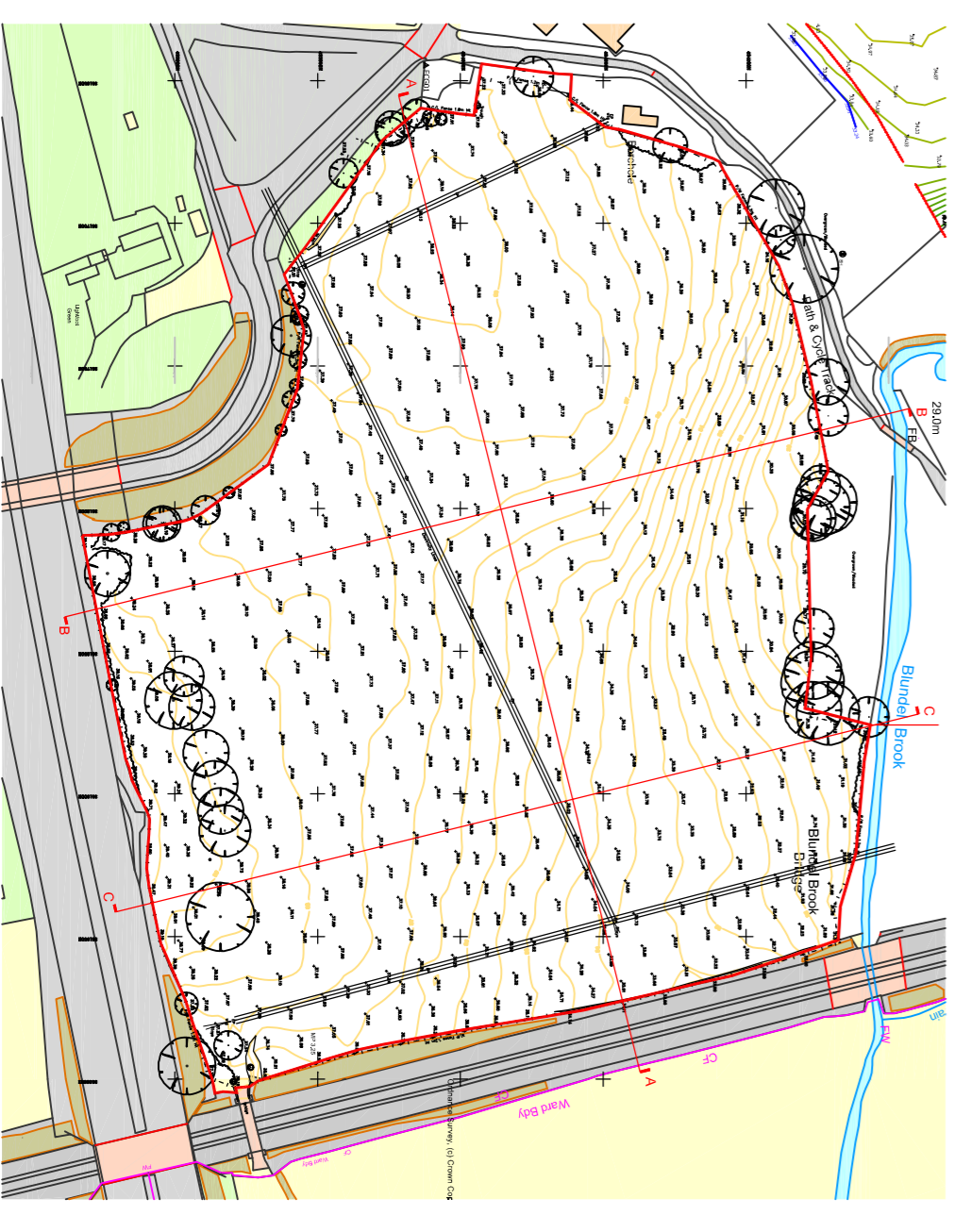

| | | | |
|---|----------------------------|----------------------|----------------------|
| CLIENT JA Jackson Contractors Ltd | | CHECKED BC | |
| PROJECT Proposed Residential Development Lightfoot Green, Fulwood, Preston | | REVISION | |
| DRAWING TITLE Existing Site Sections | | | |
| SCALE 1:500@A1 | DATE August 2018 | DRAWN MK | CHECKED BC |
| DRG NO. 6126_L01 | REVISION | | |

FWP
6 & 7 RIBBLESDALE PLACE
TRUSTEE HOUSE, 2568A
FULWOOD, PRESTON, LANCASHIRE
PR10 2JG
F: 01772 203375
E: mail@wfp.co.uk
www.wfp.co.uk

Frank White Partnership Limited