

Contractors must check all dimensions from site
 This drawing is copyright and is for use on this site only. This drawing should be read in conjunction with all relevant consultants drawings and specialist subcontractors / supply chain drawings and specifications.
 All works to be carried out in accordance with the latest British Standards / Codes of Practice unless specifically directed otherwise in the specification.

Responsibility for the reproduction of this drawing in paper form, or issued in electronic format, lies with the recipient to check that all information has been replicated in full and is correct when compared to the original paper or electronic image.

Graphical representations of equipment on this drawing have been co-ordinated, but are approximations only. Please refer to the specifications and / or details for actual sizes and / or specific contractor construction information.

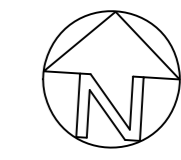

KEY

- Landscape Items to Remove**
- Trees to be removed
 - Shrubs to be removed

- Hard Landscape (Kerbs and Edging)**
- K1 Kerb (Pin) Standard PCC flat top pin kerb edging
 - K2 Kerb (Road) Standard PCC half-battered bull nose kerb: Light grey, 125mm kerf face
 - K3 Kerb (Road) Standard PCC flush kerbs: Light grey, right and left drop with flush centre

- Hard Landscape (Surfacing)**
- P1 Tactile paving Standard PCC tactile pavers 400x400x6mm in two rows. Colour: Buff
 - P2 Pedestrian Tarmac Black top wearing surface for pedestrian areas designed to engineers detail. Colour: Black.

- Hard Landscape (Items)**
- B Bollards Furnitubes Zenith, Satin polished, stainless steel bollard - 900mm high & 140mm diameter
 - Potential Land Drain
 - Existing Lighting columns reduced to one head

- Soft Landscape (Planting)**
- Shrub Planting
 - Bulb Planting
 - Amenity Grass - Turf
 - Amenity Grass - Seed
 - Specimen Shrub Planting
 - Tree Select Standard

PLANTING PLAN

QTY	UNIT CODE	PLANT NAME	STOCK	SIZE	SPACING
Shrubs					
60	No.	Cot Bea 2L	Cotoneaster "Coral Beauty"	C 2L	30-40cm 3/m2
183	No.	Euo Gai 2L	Euonymus fortunei "Emerald Gaiety"	C 2L	20-30cm 4/m2
1	No.	Pho Var	Phormium tenax "Variegata"	C 3L	40-50cm 2/m2
23	No.	Mah Apo	Mahonia aquifolium "Apollo"	C 3L	30-40cm 3/m2
32	No.	Pac ter	Pachyandra terminalis	C 2L	15-20cm 4/m2
1	No.	Pho Var	Phormium tenax "Variegata"	C 3L	40-60cm 2/m2
Herbaceous plants					
45	No.	Cro Luc	Crocossia "Lustfer"	C 2L	5/m2
Trees					
3	No.	ACE PLA ss	Acer platanoides	RB STD	14-16cm
2	No.	ALN GLU xhs	Alnus glutinosa	RB STD	14-16cm
2	No.	AME HIL hs	Amelanchier x grandiflora "Robin Hill"	RB STD	14-16cm
Bulb planting					
166	m2	Nar Feb	Narcissus "February Gold"	7/8cm Corn	To achieve natural look, throw bulb mix up in the air and plant exactly where they land
Grass Seed					
465	m2	Grass Seed	A22 - Low maintenance from BSH	Seed	50 g/m2 sowing rate
Grass Turf					
258	m2	Grass Turf	Turf to comply with BS 3969	Turf	Comply with BS 3969

Notes and Abbreviations
 B = Bare root (bagged).
 C = Container (or pot) grown, followed by size of the container (or pot).
 QTY = Quantity.
 RB = Rootballed (balled and wrapped).
 RT = Root Trainer in cubic centimetres.
 SIZE = Height or spread of juvenile plant.
 STOCK = Root condition/protection method eg Bare root.
 - Refer to specification for further information.
 - All plants to be completely hardened off.
 - Substitutions to be agreed with Landscape Architect.

GENERAL PLANTING:
 Existing trees to be retained are to be protected from damage during all site works.
 All planting will be carried out at the appropriate time of year where ever possible:
Deciduous trees and shrubs: late October to late March.
Conifers and Evergreens: September/October or April/May
Herbaceous plants: September/October or March/April
Container grown plants: at any time if ground and weather conditions are favourable.
Dried bulbs, corms and tubers: September/October

Any imported topsoil required will comply with BS3882. Soil to be cultivated to 450mm for all shrub planting areas and 150mm for grass. All plant material to be materially undamaged, sturdy, healthy, vigorous, of balanced shape and without elongated shoots. They will be hardy, healthy specimens and comply with BS 3969.

TREE PLANTING:
 Trees to be retained to BS 5837:2012. Supply and plant trees in accordance with Planting Schedule to BS 8545:2014, in locations as shown and fixed by underground guying. Plant in pits of 1000x1000x1000mm: loosen base and fork sides of pit. Backfill with 80L TP compost mixed with topsoil and 50g per pit of Enmag slow release fertiliser, or equal and approved. Spray rootball with Mycorrhizal Roots (TM) as supplied by ALS or equivalent and approved, at a rate of 450mg/500Ltr. Trm clear around trunk with 75mm composted bark mulch.

SHRUB PLANTING:
 Excavate 1-2 days (maximum) before planting. Sizes 150mm wider than roots when fully spread and 300mm deep. Pit bottom improvements: break up bottom to a depth of 150mm, incorporating 25g of slow release fertilizer per planting pit. Minimum 450mm topsoil. Apply 75mm of composted bark mulch.

C	05/01/15	Plan update to planners comments	AG	MK
B	04/12/14	Planning - update to BS Stanards	AG	MK
A	24/10/14	Planning	AG	MK
Rev.	Date.	Description.	Drawn	Chk'd



21 Swan Street, Manchester, M4 5JJ. Tel. (0161) 312 3131
 www.urbangreen-space.co.uk hello@urbangreen-space.co.uk

Client:	FWP		
Project:	Preston Royal Hospital		
Title:	Landscape Plan		
Status:	Planning		
Project:	10742	Drawn:	AG
Scale	@A1 1:200	Date:	05/01/15
Checked:	DL	Approved:	MK
Revision:	C		

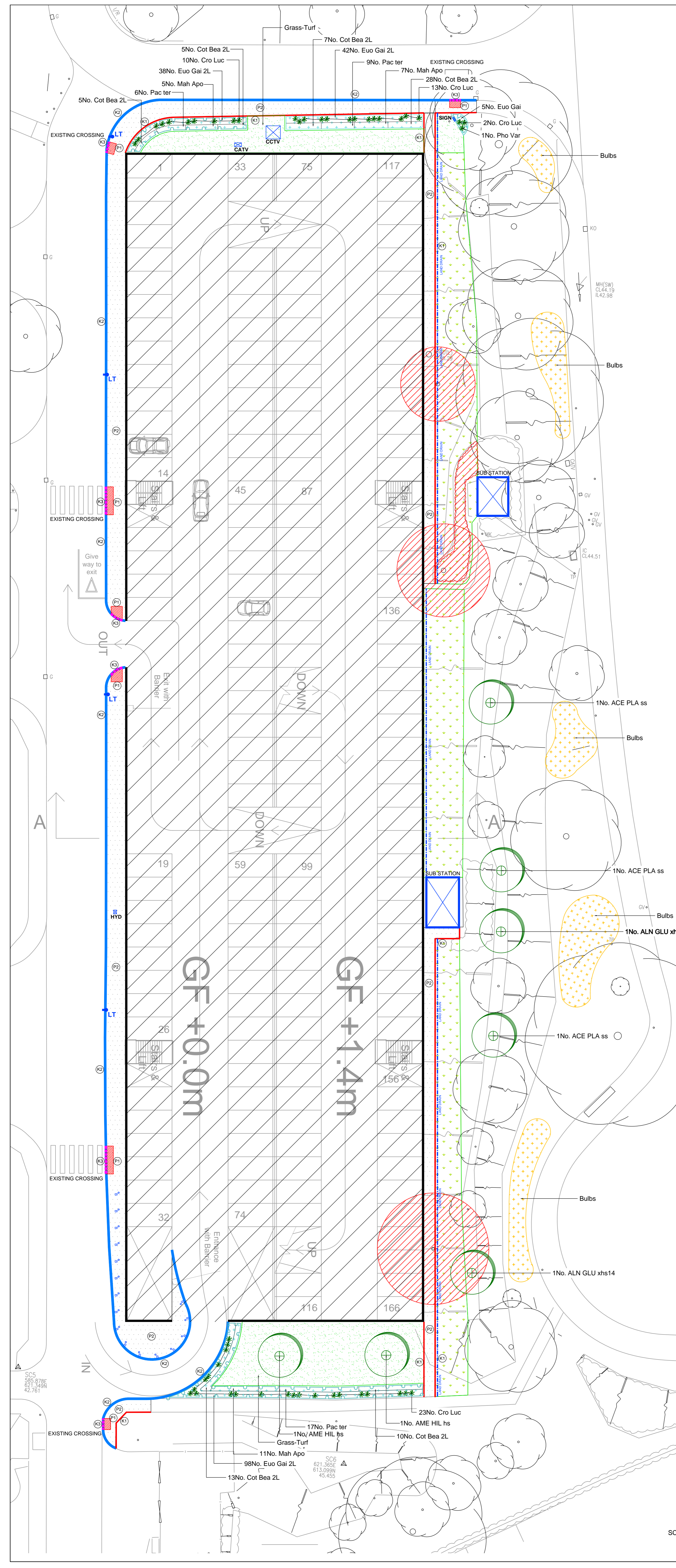
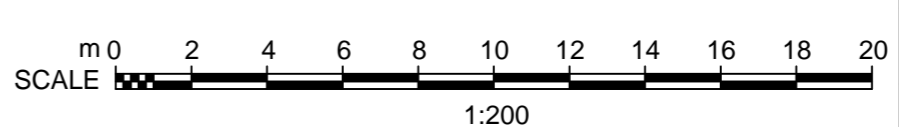

SC5
 965-878E
 621-349N
 42.761

SC6
 621.365E
 613.099N
 45.455